

Key projects

4

4.0 **Arrival Experience**

“We aim to be among the best in the world in a number of research areas that address the big social and environmental issues of our time.”

Future Ready: Strategic Plan 2013-2017



4.1 Key projects

INTRODUCTION

This chapter describes in more detail, selected key projects that could be implemented in the first ten years of the 2017 Master Plan.

The vision for each project and key moves are shown, together with precedent examples.

- 1. University Drive and Campus Green
- 2. Sports education, amenity and regional accommodation
- 3. Student hub
- 4. The 'Corner'
- 5. Library extension
- 6. Building 4 reconfiguration and informal learning
- 7. Research collaboration and expansion
- 8. Sports pavilion and pitch upgrades
- 9. Wetlands upgrade



1.

University Drive

University Drive is the first experience of the campus for many visitors, and will continue to play an important role in years to come. Currently, there is no through transit access on University Drive. This Master Plan proposes to connect the road between the University and Wodonga TAFE, creating a central, combined entrance for each campus. Public transport connections through the campus from Wodonga and the surrounding region could be improved in addition to the arrival experience.

Bus routes could be directed along University Drive, creating a more direct and legible route through the campus.

Consultation sessions conducted as part of the Master Plan process with Public Transport Victoria (PTV), Dysons bus operators, the City of Wodonga and members of the La Trobe University community have showed wide support for this intervention.

Over the next 20 years this central campus area could be progressively upgraded, with high-quality landscape and urban realm as well as University and community buildings.

University Drive could be lined with trees to enhance the arrival experience. Within the Knowledge Village precinct the University Drive pavement could be raised with a top surface treatment to match the Discovery Way pedestrian spine.

The planned arrival centre could include a student hub and accelerator spaces, student accommodation, hospitality offerings, extended-hour library facilities and a community hub with indoor sporting facilities, generating a locus of activity in keeping with the significance of this location.

The new buildings along the east and west of University Drive could cater for the student and community population growth. These buildings could be of an institutional scale and face both University Drive and the education spine Discovery Way. They could be transparent and accessible on the ground floor, providing a welcoming presence on the street.

These upgrades could be introduced together with proposed upgrades to Discovery Way pedestrian spine creating a safe pedestrian-focused zone at the central crossing point between La Trobe University and Wodonga TAFE, creating a pathway to learning.

Signage, sculpture and landscape upgrades could help celebrate the entrance to the Campus.

Campus Green

The Campus Green is proposed as a formal landscaped gathering, events and informal sports space. The Campus Green is unique from the native landscape character on campus as it could be programmed for use and remain an activated and safe space for students to use during and after hours.

As the forecourt for the Community Commons and the meeting point of the proposed Recreation spine, Discovery Way and University Drive, the Campus Green could become a dynamic place where informal recreation and performances can take place. The Commons Green could step up to create a stage, while also providing flat green space for picnics or barbecues. Students, staff and visitors can watch outdoor cinema, or participate in activities, such as dance or yoga.

The Campus Green is well located adjacent to the sports fields, the proposed bus terminal and the existing library. It is also north-facing, providing good solar access.



Monash Caulfield Campus Green



The Goods Line, UTS.



Hasting Street, Noosa



Moonlight cinema, Perth

University Drive and Campus Green

SCALE 1:500

KEY DESIGN DIRECTIONS

- 1. New bus stop adjacent to David Mann Library
- 2. Connections upgrades to University Drive, pedestrian paths and crossings
- 3. Stepped seating for performance
- 4. New north-facing Campus Green
- 5. Outdoor cinema and events space



Campus Green

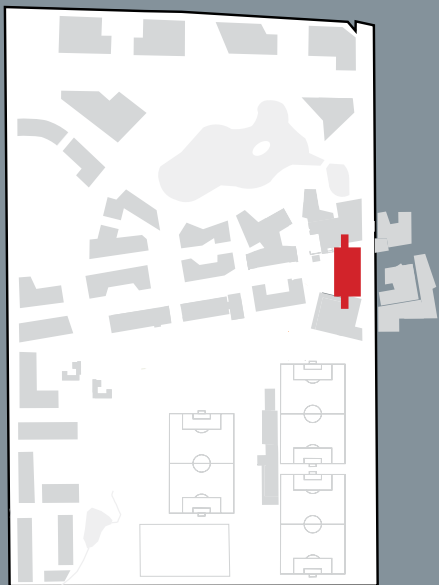

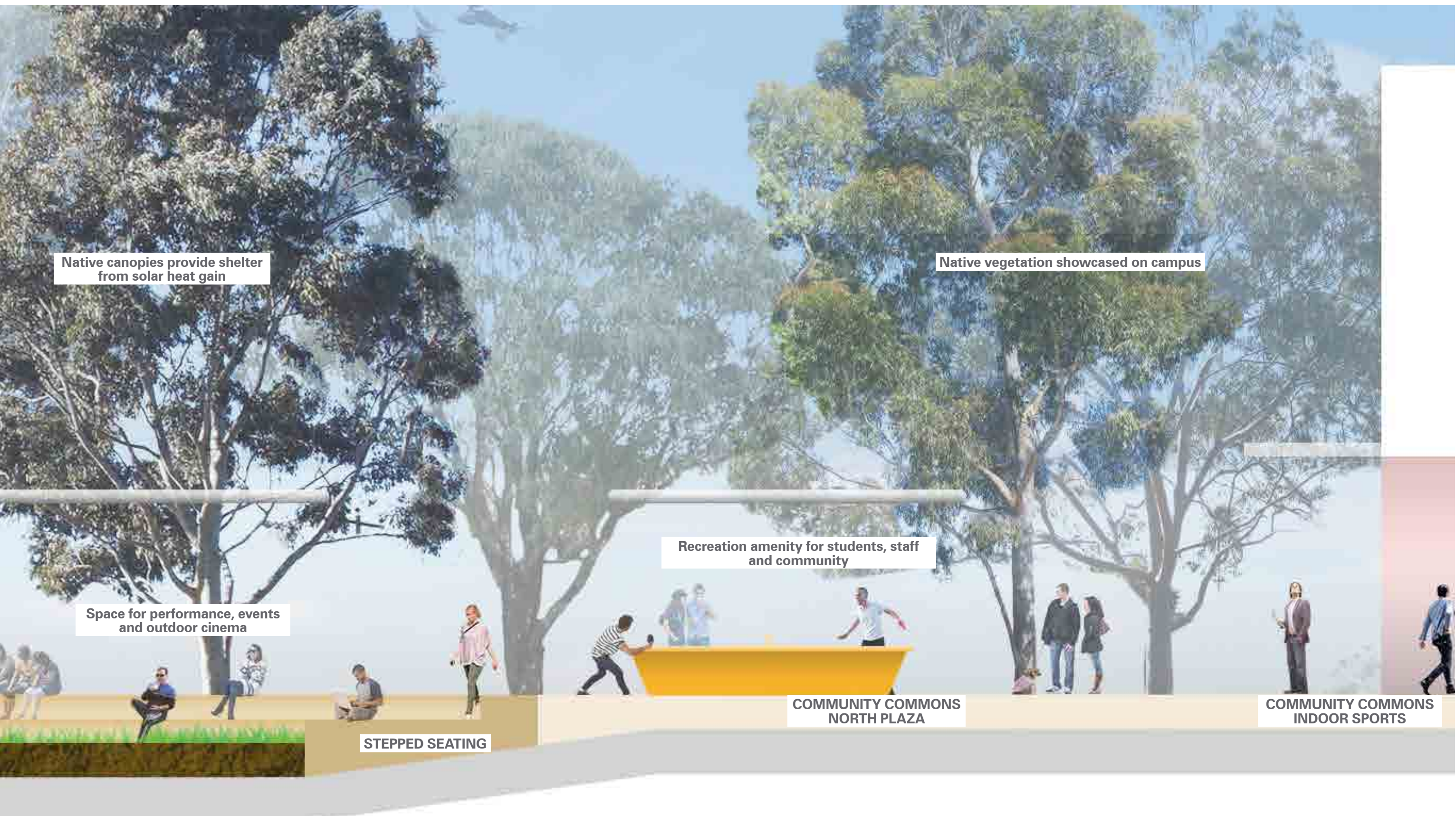

Native canopies provide shelter from solar heat gain

Native vegetation showcased on campus

Space for performance, events and outdoor cinema

Recreation amenity for students, staff and community

STEPPED SEATING

COMMUNITY COMMONS NORTH PLAZA

COMMUNITY COMMONS INDOOR SPORTS

0
1
2m

2.

Community Commons

Sporting facilities encourage engagement with the local community. In Wodonga there are several sporting teams who gather weekly to socialise, exercise and compete. The Community Commons facility could be used to support research and student sports training and could also become a local hub for the community in West Wodonga.

Located behind the Campus Green this new facility could provide valuable services to La Trobe University students and staff, regional sports teams and the regional community by providing spaces for indoor sports, sport science, coaching and training, generic health sciences, bookable meeting rooms and informal learning areas. Any formal sporting areas could be managed so that they can be booked and utilised by local sporting groups as well as the University.

The Community Commons could introduce extra changing rooms, sports storage, outdoor seating and indoor sports as an extension of the existing Sports precinct. It could also act as events space able to accommodate markets, festivals and events for the local student and community population as an extension of the Campus Green.

The Community Commons could feature an indoor flat floor space which could comfortably fit two indoor basketball courts. Further facilities such as end-of-trip cycle facilities, sport testing centre, flexible spaces, with a foyer and an entrance area to student accommodation on upper levels.

Sports education

There is opportunity for sports exercise science, exercise physiology and sports medicine at Albury-Wodonga, which could be developed as part of the curriculum for the campus.

Equally, there is potential to bolster sport courses, such as Sport Coaching and Sport Development and Management, as a pathway from either or both the generic Diploma of Health Sciences or Diploma of Sport Development, which could also be offered by Wodonga TAFE. These Diplomas would usually provide 8 subjects of credit into these degrees.

Both levels of courses could utilise the Community Commons indoor facilities as well as the existing Sports precinct pitches or the proposed upgraded synthetic pitch for practical sessions.

Regional accommodation

Student or short-term accommodation could be located about the Community Commons. This concept is explored further in Section 3.6 Housing strategy.



Sports hall, Cambridge University



John Street apartments



Cambridge University



Permeable dance/yoga hall

Sports education, amenity and regional accommodation

SCALE 1:500

KEY DESIGN DIRECTIONS

- 1. Indoor sporting facilities
- 2. Regional accommodation core campus
- 3. Dance and yoga space
- 4. Sports and generic health science.
- 5. Proximity to Knowledge Village and Sports precinct



4.4 Student hub

3.

Student hub

A new central student hub could be sited on the north-east corner of the Knowledge Village precinct with views towards University Drive and the David Mann Library.

The Student Hub could be a joint development with Wodonga TAFE providing a key tool in improving learning and teaching support, administrative services and a highly accessible contact centre with extended operating times.

This building could be a welcome centre and one-stop-shop for administration and student services and also incorporate the latest digital technology and flexible teaching spaces to support contemporary pedagogy. The Student Hub could provide student enrolment, administration, support services, counselling, academic skills development and support, peer support, career advice and guidance.

These spaces within the Student Hub could include advanced technology-based flexible meeting rooms for group work activities and technology based collaboration with other locations; small meeting rooms for one-on-one meeting with advisor and counsellors; quiet spaces for personal study; flexible study areas with access to shared printers; and video conferencing, computers and lounge areas.

Accelerator space

There is an opportunity for an accelerator space to be showcased within this Student Hub. The lower floors could be open and transparent, facing on to Discovery Way pedestrian spine and showcase innovation and research. The upper floors could contain flexible teaching spaces, group discussion and additional faculty decanting space. In the shorter term, an accelerator space could be located in Building 4 (AW4).



Transit shelter - University of Penn



Eldon West Building - University of Portsmouth



Superpool Open Library).



Render of proposed Student Hub, MGS

Student hub

SCALE 1:500

KEY DESIGN DIRECTIONS

- 1. Transit shelter and public architecture
- 2. Student Services and accelerator space
- 3. Informal learning and gathering
- 4. Outdoor seating and bike amenity
- 5. Proximity to hospitality offering



4.

The 'Corner'

The planned campus development and the blurring of boundaries with surrounding communities, plus the expected population growth in Wodonga will present a need for local community services in West Wodonga.

A community hub on campus could provide the community with links to indigenous and cultural facilities such as indoor gathering spaces, hall hire for corporate functions, social occasions and weddings and end-of-trip facilities into the campus core as part of a convenient campus experience and lifestyle.

While supporting an extended-hour campus lifestyle which could be enhanced by Wodonga TAFE hospitality curriculum there is demand for an improved La Trobe University hospitality offering. A new social space for informal gathering could bring much needed centralised activity into the Knowledge Village.

This community hub and pub could offer food and beverage during campus hours, also after-hours for community and those staying on campus, as well as on weekends as post game/ post course socialising space.

The extension to this could be a microbrewery utilising the advanced horticulture and agricultural skills from Wodonga TAFE students. This could be used for both learning and teaching while students participate in courses that allow them practical skills within this facility.

Taking into consideration showcasing sustainability initiatives, there are systems such as the Gaia Recycle water and biowaste system, compost/fertiliser systems that could work to the back of house and lead to community education and acceptance for new practices.

An extension to the arrival plaza could be a paved plaza space to the south of this facility offering pop-up services from Wodonga TAFE such as massage services, and specialised skills appropriate to arts and crafts markets.

Regional accommodation

It has been identified that the Albury-Wodonga campus needs to provide a wide variety of centrally located housing options, to support activity and build community for approximately 20% of the projected student population in 2036 residing on campus.

A cognitive shift is required to move from solely college style accommodation to more diverse forms of accommodation.

Mixed, short-term and intergenerational accommodation types could be considered in the design and development of accommodation above the new social space below as well as above the Community Commons.

As beacons of activity with north light and landscape aspect, not only creating passive surveillance for the campus and in turn increasing safety, accommodation in the Knowledge Village could be a marketable asset for the La Trobe University for exchanging short course and study groups between campuses.

Subject to demand assessment the short-stay accommodation may be used for visiting staff, conference guests, sporting teams and block learning students.

Accommodation could include double beds, mini fridges and other amenities to allow for flexibility of use. The new building could be able to cater for 100 self-contained studio units, four storeys above ground floor.



John Street apartments, Box Hill



Wollongong children's museum



University of Washington



Simon and Helen Director Park

The 'Corner'

SCALE 1:500

KEY DESIGN DIRECTIONS

- 1. New central pub and microbrewery venue
- 2. Regional accommodation core campus
- 3. Second offset bus stop
- 4. 'Pop-up' Plaza space for markets
- 5. Waste and compost ESD initiative



Recreation spine

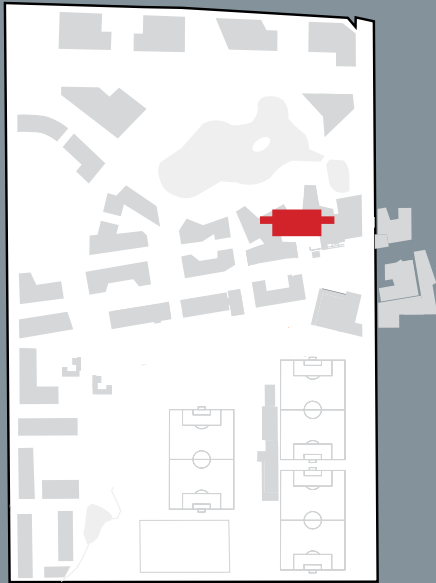

Native vegetation showcased on campus

Native canopies provide shelter from solar heat gain

AW 3

Upgraded pedestrian network

Rest amenity

LANDSCAPED URBAN REALM AND AMENITY

BOULEVARD PLANTING



DAVID MANN LIBRARY

LIBRARY EXTENSION

4.6 Library extension

5.

Library extension

Extended opening hours have been identified as necessary to meet flexible student needs. Students may be studying after hours and with other priorities, in this case an extension of the existing David Mann Library could work effectively.

With limited and managed operating hours a library extension with a cafe offering may provide a safe quiet learning space with amenity on campus.

As well as providing access directly into the library during regular hours, this extension could operate as a separate entity when required reaching out to University Drive enabling students to alight from bus transit and safely cross to an after-hours study space.

Facing onto the arrival plaza, the library extension could strengthen its role as the academic and social heart of the campus.

This concept focuses on enhancing the quality and variety of learning and teaching spaces on campus. It has been identified that the introduction of blended learning styles has necessitated that classrooms become more flexible and digitally connected, with informal areas suitable for group work and after-hours activities without necessitating staff resourcing.

The library extension may also see technologically advanced spaces and studying spaces with improved outlook over the native landscape wetland and potential Yarning circle.

This concept further acknowledges the planned Student Hub as a shared student services facility east University Drive across from the library.

The extension to the existing library building and the new Student Services building could frame the arrival plaza and could have a consistent and contemporary character. The ground floor of both of these buildings could be activated with functions such as retail, hospitality, information services, building entrances, staff and alumni spaces, and bookable study rooms, creating an activity and information hub to service both students and the wider community.

Both indoor and outdoor spaces around the library extension could be fully WiFi enabled to encourage a free flow of students between spaces whilst digitally connected to online learning media.

The neighbourhood community can similarly be encouraged to linger on campus by providing a WiFi guest network within the campus core.



Cambridge University



Cambridge University



Bendigo Library, MGS



University of Newcastle

Library extension

SCALE 1:500

KEY DESIGN DIRECTIONS

- 1. Central cafe hospitality offering and
- 2. Extended-hour learning annex and community gathering space
- 3. Informal learning with aspect out to the wetlands and board walk
- 4. Permanent lake as gateway marker
- 5. Yarning circle



Discovery Way

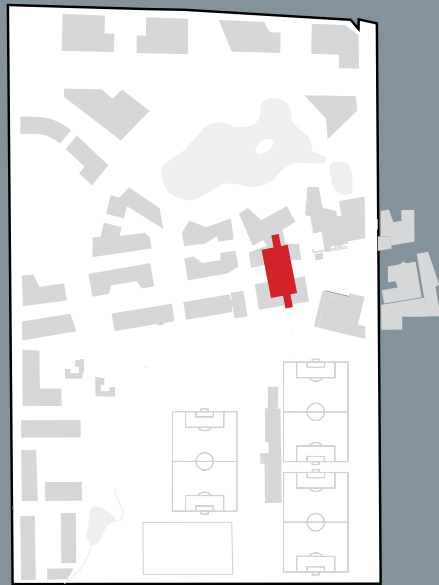

AW4

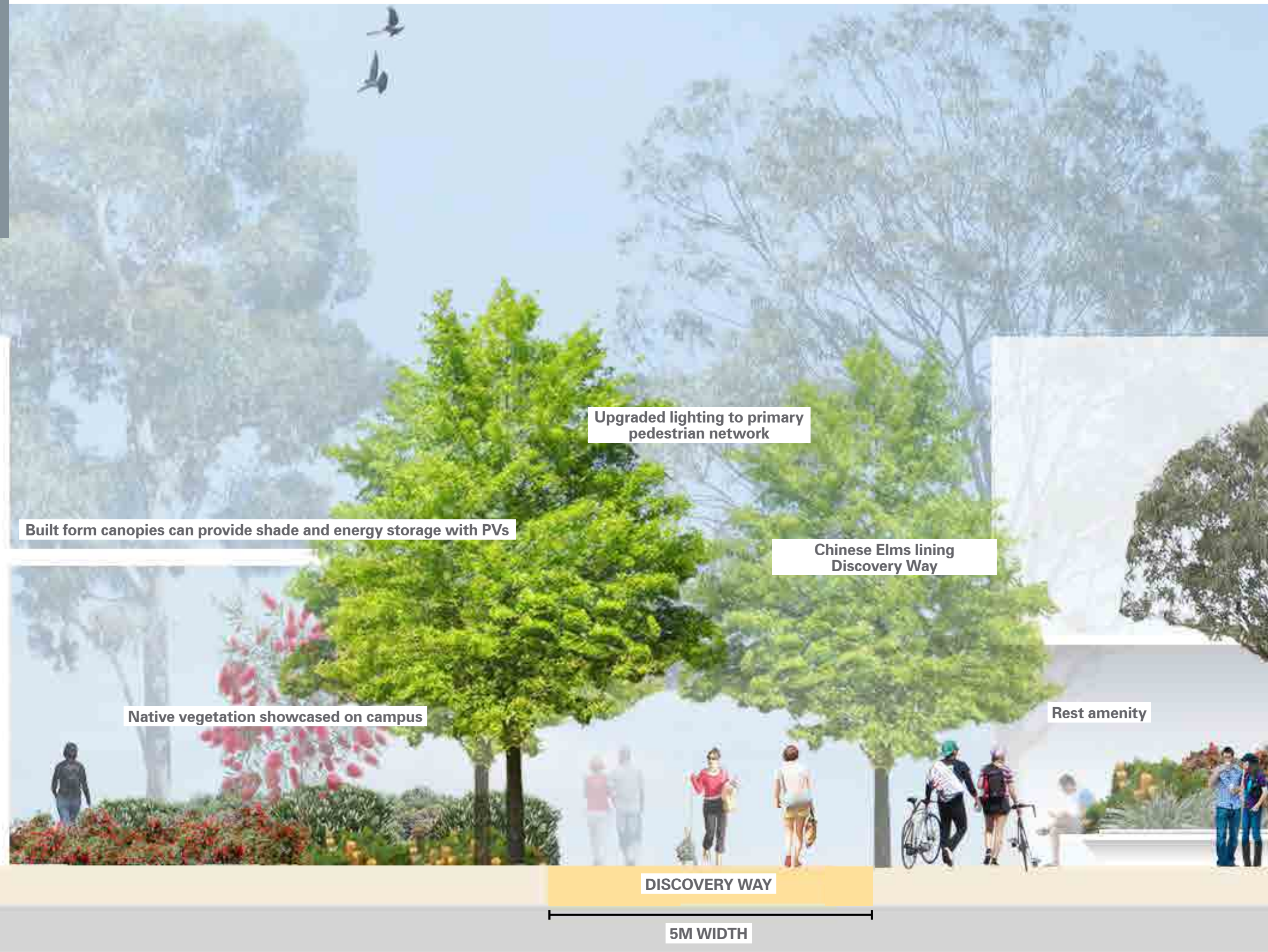



Native canopies provide shelter from solar heat gain



INFORMAL GATHERING PLAZA SPACES

LANDSCAPED SEATING

CYCLING APPROPRIATE SURFACES

AW3

0
1
2m

4.7 Building 4 reconfiguration and informal learning

6.

Building 4 (AW4) Upgrade

AW4 could facilitate contemporary facilities to create flexible multifunction spaces that could improve student experience and a collaborative teaching initiative could strengthen the relationship to neighbouring teaching facilities.

There is an opportunity to extend AW4 closer to the Campus Green and Discovery Way in order to provide undercover weather protection, activity pavilions and informal gathering spaces. The upgrade also takes into consideration programme and proximity to the Community Commons and David Mann Library, providing an inclusive student / future student focused and public services zone, while also accommodating student services focused staff and a new welcoming, eastern facade.

AW4 could offer a variety of informal learning spaces, student/staff bookable spaces, collaborative teaching spaces, video conferencing facilities, open plan offices, discreet individual offices, and counselling rooms. A contemporary reception pod design is to be employed, similar to the La Trobe Bundoora Future Student shop front concept.

The immediate external space to the eastern facade of AW4 with its outlook onto the Campus Green could be developed to create informal hotspots. There is also opportunity to continue informal hotspots dotted along the Recreation spine past AW4 and Community Commons past the library. These areas could have access to WiFi, outdoor cinema viewing and landscape amenity.

Renovation and extension of Building 3 (AW3)

AW3, while in good condition, would benefit from significant upgrades to learning and teaching spaces and an extension towards the ephemeral wetland.

This extension of AW3 could become a new learning and teaching facility for the University's expanding flexible spaces and offering large conferencing facilities with stepped seating and an aspect out to the wetlands.

A number of flexible learning and teaching spaces could be joined together with Building 3 via a central lobby with stairs and a lift core.

AW3 could be a world class facility available for research conferences for regional and native discussion and presentation. This building could be specifically designed to take full advantage of the connection with the wetland through a board walk to the north on the ground floor and permeable façades for outlook, amenity and connection with the research buildings to the west.



Open-Air Library, Magdeburg, Germany



UC Irvine, Contemporary arts centre, Southern California



Bendigo Library, MGS



UQ Oral Health Centre, School of Dentistry, Brisbane

Building 4 reconfiguration and informal learning

SCALE 1:500

KEY DESIGN DIRECTIONS

- 1. Extension of AW4
- 2. Visual and physical connection
- 3. Formal learning
- 4. Shade canopies
- 5. Informal learning
- 6. Extension of AW3 with flexible teaching spaces and aspect to Wetlands

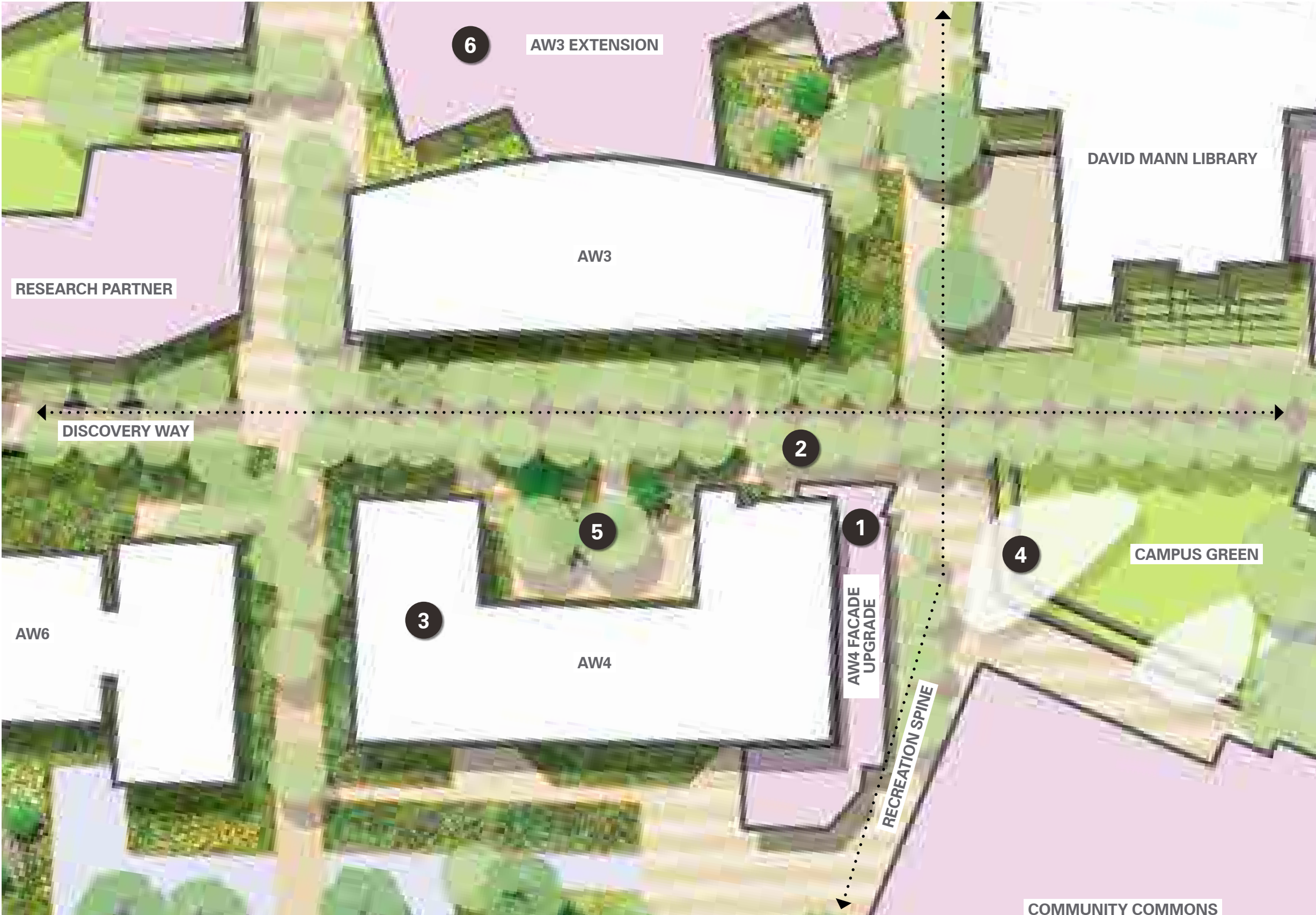

4.8 **Research collaboration and expansion**

7.

Research expansion

The Albury-Wodonga campus has strong capacity within water and healthy ageing research. This can be leveraged to gain additional research partners and grow the campus into a stronger and more significant locus of research and innovation in the region.

Consultations with staff have highlighted the need to renovate and extend some of the existing facilities to include a wider variety of informal spaces and breakout areas. There is also a need to create more opportunities for outlook and daylight. The research connector and welcome centre could provide a heightened presence of research on campus both physically and academically.

The need for a number of improvements to the amenity, flexibility and connectivity between research spaces and the rest of the campus have been identified. By connecting AW6 and AW8, staff and students could access new informal breakout spaces, a conservatory style learning lab and a joint entry lobby and visitor welcome centre. There is additionally potential to locate some teaching labs along the frontage towards the car park in order to advertise the research activities within the precinct.

The expansion of research activity and partnership as well as accelerator or incubator centres, would develop buildings within the Research precinct north of Discovery Way.

The wetlands could further service water and sustainability research activities.



Office, Silicon Valley



Geyer CPA



George Brown College



Princeton University

Research collaboration and expansion

SCALE 1:1000

KEY DESIGN DIRECTIONS

- 1. New research facilities and collaborative spaces
- 2. Research welcome centre
- 3. Research, academic and incubator space with aspect
- 4. Physical access to board walk and recreation amenity
- 5. Wetlands upgrade and filter

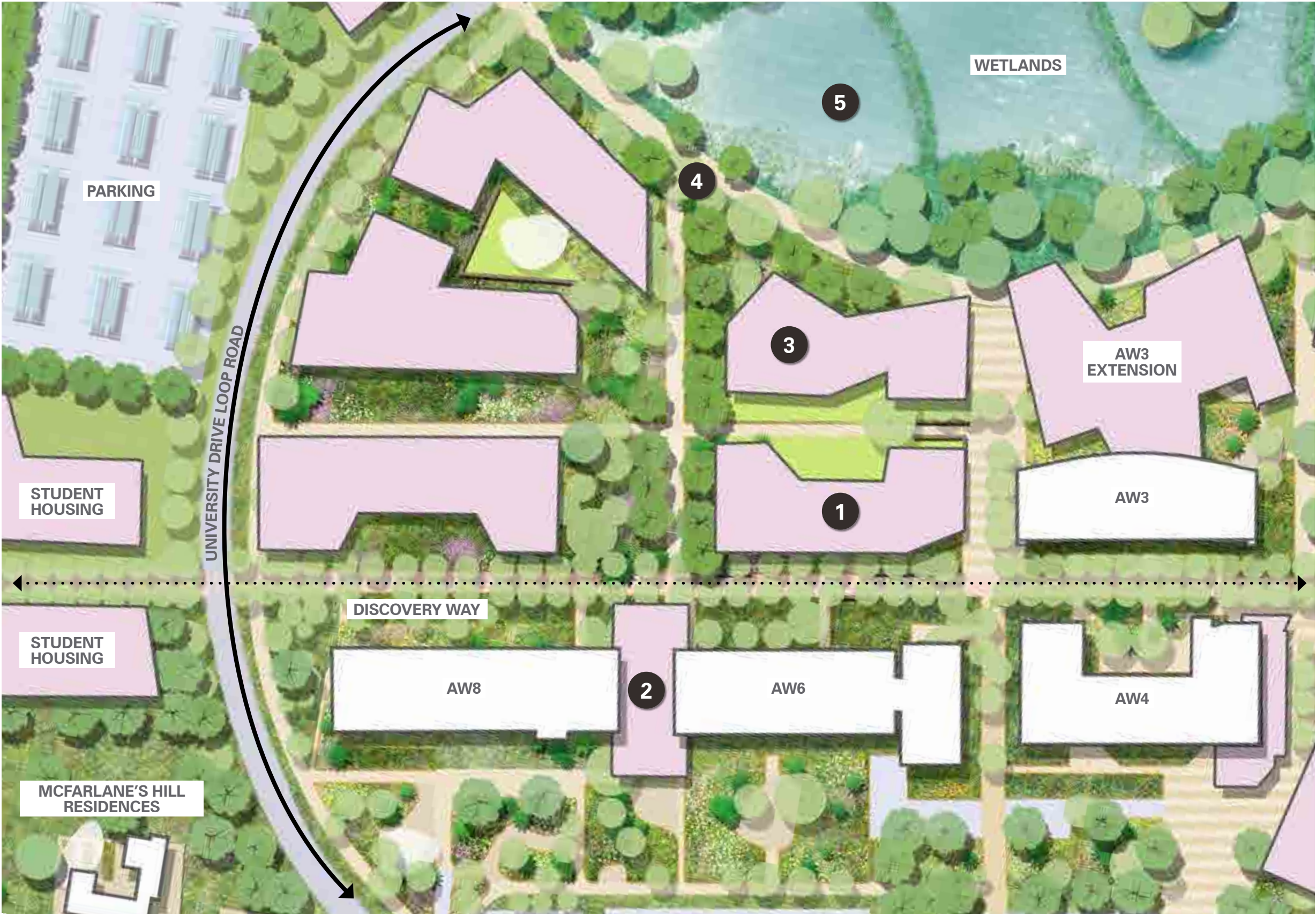

8.

Sporting pitches upgrades

There is strong interest in sports and recreation in Wodonga. The Albury-Wodonga campus Sports precinct could provide a coherent sports and recreation strategy including improved sporting pitches and amenity for both students and the out-of-hours community of users.

By moving pitch 01 towards the north, Pitch 03 can fit in a north-south orientation directly beneath providing increased pitch space for all user groups.

La Trobe University could work with the existing sport partners and the local council to develop at least 1 synthetic multi-purpose pitch with lights (a 3G surface suitable for soccer, rugby, lacrosse) on the pitch 01 adjacent to the existing clubrooms with further upgraded lighting around the pitches and along the Recreation spine.

This could facilitate greater programming of additional sport activities with external sport organisations, provide a sustainable space for future daytime sport activities for university and TAFE students, and facilitate the delivery of potential new sport-related courses.

A separate training and coaching outdoor pitch has been identified as necessary due to increased demand for the campus pitches. Pitch 04 can be accommodated to the south of Pitch 02 in an east-west orientation and at a smaller scale to a full sized pitch. This surface may also need some considered landscaping to account for the increased topography in the proposed area.

Pitch 02 also has capacity for use as an oval or rectangular playing surface.

Sports pavilion extension

A gym and sports science facility could be included in a separate pavilion or else within the Community Commons building.

There is also potential for an extension of the existing sports pavilion facing east over pitch 01 as promoted by the Wodonga Diamonds Football Club (WDFC). The extension could provide improved team and/or venue spaces and greater flexibility for seating areas. The existing water tanks to the west of the pavilion could be relocated to a more suitable and contained location south of the pavilion.

The separate pavilion to the south would face west over pitch 02 and provide an event space to the upper level.

Recreation spine

The Recreation spine on campus could link the Sports precinct and Discovery Way. This could provide a safe accessible path in all hours with designed paving, planting, lighting and wayfinding.

The Recreation spine could attract the main pedestrian flow into the Knowledge Village precinct encouraging interaction with informal learning, research facilities and improved community facilities and hospitality offering.

By running the Recreation spine past AW 3 a greater connection with the wetland can also be achieved.

A second link within the Sports precinct may facilitate a pedestrian connection between the existing indoor sports and tennis courts of Victory Lutheran College (VLC) and the Research precinct of La Trobe University. It could also link the VLC with University Drive along the southern University property boundary.



3G Synthetic pitch



Keast Park



Wodonga Diamonds Football Club (WDFC)



Sports greens that allow informal group fitness training.

Sports pavilion and pitch upgrade

KEY DESIGN DIRECTIONS

- 1. All-weather synthetic Pitch 01 upgrade (3G) and upgrade to lighting
- 2. Potential oval lateral movable pitch work - as required - Pitch 02
- 3. Additional pitch to south - Pitch 03
- 4. 5. Training and coaching - Pitch 04
- 5. Sports partnership for pavilion extensions



Wetlands and the Yarning circle

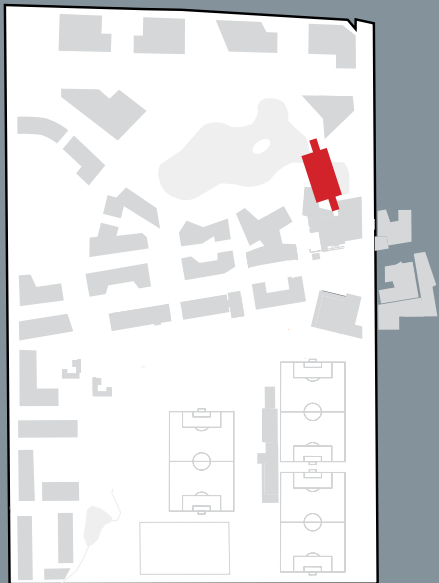



BOULEVARD PLANTING

YARNING CIRCLE

PERMANENT WETLANDS

9.

Wetlands upgrade

The La Trobe Albury-Wodonga campus forms part of a larger ecological context and connects to various vegetation and wildlife corridors. The Wodonga Wetlands in the north, feed into the Murray River and the Wodonga Regional Park towards the north-east.

The campus' proximity to the Wodonga Wetlands provides a unique opportunity to supplement and showcase the existing ecology, to plant dry-climate vegetation appropriate for the Albury-Wodonga region and to utilise local species to re-vegetate areas of the site, as appropriate in the regional context.

There is a retarding basin to the north of campus which seasonally fills with water. Almost completely dry in the summer months this ephemeral wetlands currently provides for a multitude of native flora and fauna and could be further upgraded to showcase water conservation including capture, treatment and storage of water around the site and relating to buildings and infrastructure.

The landscapes around the wetlands could be upgraded to include a running track, board walk and Yarning circle connected to the Recreation spine. The built form, including the library extension and research partners, could extend up to have aspect over the wetlands, connecting learning, teaching and research to the campus water focus.

The existing eco-corridor to the east within the Daintree Estate development which reaches into the Albury-Wodonga campus at the north-east corner could be connected back to the Fell Timber Creek eco-corridor on the Wodonga TAFE land by way of the ephemeral wetlands.

Provision of signage around the campus ephemeral wetland and the neighbouring wetlands could communicate the biodiversity stories of the area and create an awareness of the ecological values.

Yarning circle

A Yarning circle is a round meeting place to share local stories and connect on campus. This could provide a place of exchange between local community and the University community.

The key programming of this Yarning circle would be a learning, storytelling and discussion space. The ideal location would be an intimate space near the permanent wetlands lake and the David Mann Library on campus.

Further to this report there needs to be a Cultural and Heritage Management Plan (CHMP) undertaken with indigenous representatives for this campus to establish and record important cultural heritage aspects.

Refer to 3.11 Landscape and urban realm - places, and 5.1 Early wins 0-2years - built form and facilities.



Te Wao Nui -Dianna Wells Design



ABG Wetland, TCL



Yarning circle - Ballina State School, NSW



Yarning circle - Bremer State High School, Ipswich QLD



Stanford University



Wetlands upgrade

KEY DESIGN DIRECTIONS

- 1. Upgraded wetlands with filter for ESD and WSUD initiatives
- 2. Permanent lake as gateway marker and arrival experience
- 3. Yarning circle
- 4. Native planting and information signage along Pedestrian Boardwalk with link into Daintree Estate
- 5. Public-facing research and academic buildings

SCALE 1:1000



