

Exhibiting Information



VISUAL & DESIGN

PhyllisPalmerGallery



Aims

The Phyllis Palmer Gallery is a space dedicated to showing new work by graduates, current students and associates of La Trobe University Visual Arts as well as those that have had connections with La Trobe University. The Gallery is committed to showing the most diverse range of art works, from paintings, sculpture, ceramics, photography, graphic art, as well as new media. The Gallery aims to present innovative work, particularly work founded in contemporary ideas to the widest possible audience.

Eligibility

Artists are invited to exhibit through an official application process. No correspondence will be entered into after the official announcements are made for the annual selection of exhibitions.

Selection Criteria

Proposals from artists will be judged by the same criteria.

- quality of proposal
- originality and innovation
- relevance to contemporary ideas and art practice



Guidelines for Exhibiting

- Individual invitations are the responsibility of the exhibitor. If you require assistance please contact the Gallery Administrator.
- Exhibitor is responsible for the installation and dismantling of the show.
- Walls are to be left in the same condition as found including any painting and filling of nail holes.
- Exhibitions are normally scheduled for a three-week duration which includes a maximum of two days installation and one day dismantling and only from Monday to Friday 9.00 am – 5.00 pm.
- Technical assistance is available for the lighting and for the hanging of large works only.
- A detailed statement (approx 1/2 to 3/4 A4 page) describing the underlying concept of your exhibition. This will be used as a media release.
- Image/s in an electronic format of high resolution i.e. jpg. Images will be used for printed gallery program, advertising, web page and media requests.
- **Hiring Charges:**
No charge to current students.
A nominal fee of \$50.00 for operational expenses is required from applicants outside the university.
- **Sponsors – Bendigo Wine Estate and Food for Thought**
The Phyllis Palmer Gallery is sponsored by **Bendigo Wine Estate** and supplies up to 5 bottles of red wine and 4 bottles of white wine on the opening night. Exhibitors are expected to support the sponsor by promoting and purchasing the wine.
- **Food for Thought** sponsors finger food for the opening night.
- The Gallery will take 20% commission on any works sold.
- The artist is required to deliver a short (10 mins) floor talk about their work on the opening evening (usually at 5.30 pm).
- The artist is required to provide a list of works.
- Invigilation is provided by the University at no charge.

Gallery Equipment

Lighting

- 21 x spotlights on tracking system

Installation and hanging equipment

- J railing
- Hanging rods
- Hanging equipment (e.g. hammers, nails, hooks, etc)
- Ladders
- Spirit levels

Display Cabinets

- 11 x glass display cabinets with lighting

Plinths

- 10 x various sizes



Information Requirements

With application form (Part B)

- Exhibition Title
- Image/s
- Concept Statement A short (two sentence) concept statement. Describe clearly and concisely what you intend to exhibit and ideas inherent in the work.
- Current CV

12 weeks prior to exhibition

- Detailed exhibition statement to be used as a Media Release
- Name and title of the person who is opening the exhibition

2 weeks prior to exhibition (Part C)

- List of works (as per attached forms)



Gallery Floorplan

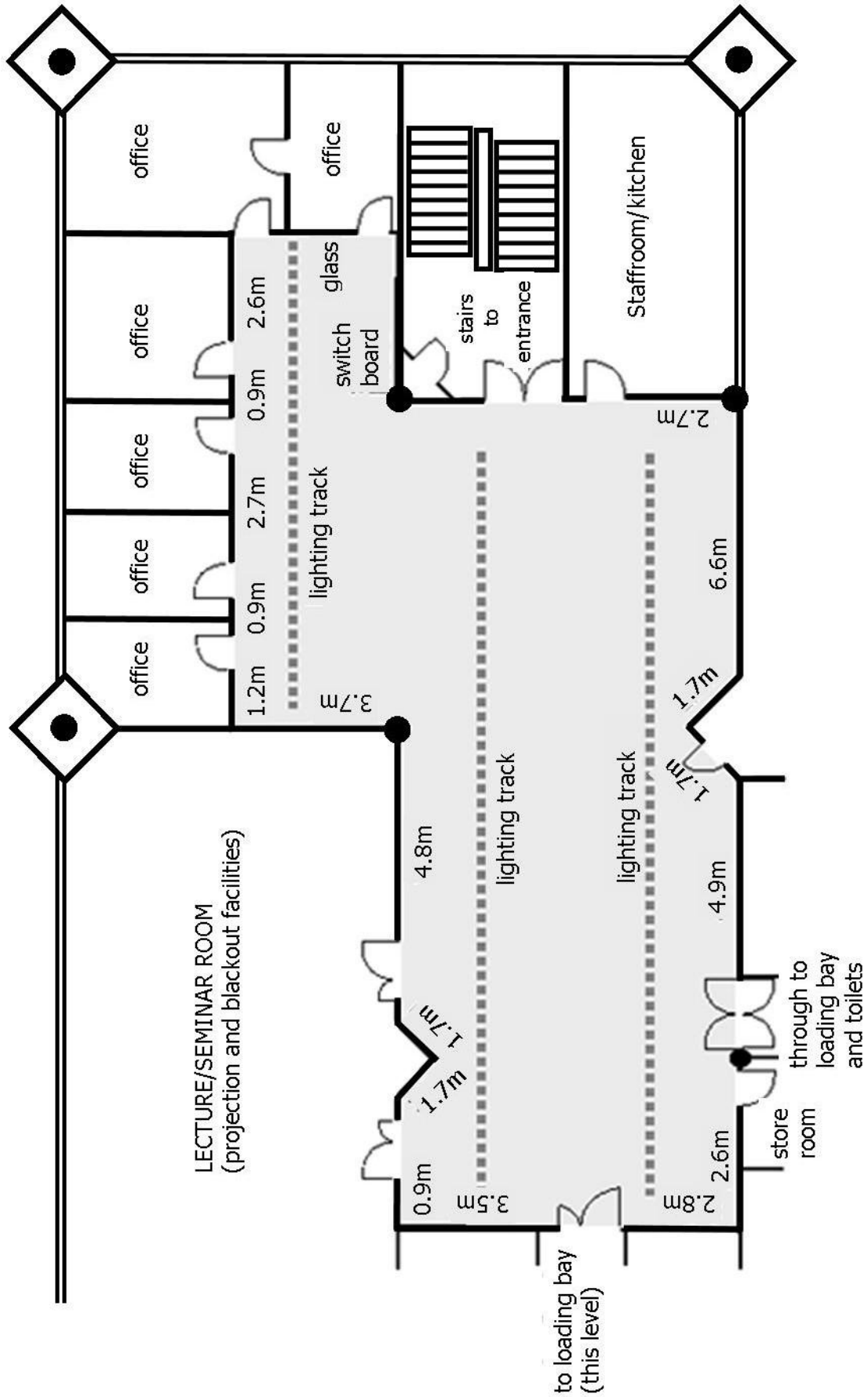

FACILITIES

47.3 meters total wall space

Wall height 2.90 metres

Lighting – track spot and daylight fluorescent banks

Exhibiting in 2012

Closing Date: 5th November, 2011

Deliver to: Candy Stevens, Level 2, School of Visual Arts & Design, Rm VA2.24

Post to: Candy Stevens, PPG Administrator, La Trobe University, Visual Arts & Design, PO Box 199, Bendigo Vic 3552.

Please print clearly

NAME: _____

ADDRESS: _____

POSTCODE: _____

TELEPHONE: _____

MOBILE: _____

EMAIL: _____

STUDENT COURSE: _____ YEAR LEVEL: _____

GRADUATE COURSE: _____ YEAR: _____

ASSOCIATE _____

FOR GROUP EXHIBITION

DETAILS OF OTHER EXHIBITORS

NAME: _____

ADDRESS: _____

POSTCODE: _____

TELEPHONE: _____

MOBILE: _____

EMAIL: _____

NAME: _____

ADDRESS: _____

POSTCODE: _____

TELEPHONE: _____

MOBILE: _____

EMAIL: _____

If more than 3 exhibitors please attach a separate list with details.



List of Works

TITLE 1: _____
YEAR: _____
MEDIUM: _____
DIMENSIONS: _____
PRICE: \$ _____

TITLE 2: _____
YEAR: _____
MEDIUM: _____
DIMENSIONS: _____
PRICE: \$ _____

TITLE 3: _____
YEAR: _____
MEDIUM: _____
DIMENSIONS: _____
PRICE: \$ _____

TITLE 4: _____
YEAR: _____
MEDIUM: _____
DIMENSIONS: _____
PRICE: \$ _____

TITLE 5: _____
YEAR: _____
MEDIUM: _____
DIMENSIONS: _____
PRICE: \$ _____

TITLE 6: _____
YEAR: _____
MEDIUM: _____
DIMENSIONS: _____
PRICE: \$ _____

TITLE 7: _____
YEAR: _____
MEDIUM: _____
DIMENSIONS: _____
PRICE: \$ _____



TITLE 8: _____
YEAR: _____
MEDIUM: _____
DIMENSIONS: _____
PRICE: \$ _____

TITLE 9: _____
YEAR: _____
MEDIUM: _____
DIMENSIONS: _____
PRICE: \$ _____

TITLE 10: _____
YEAR: _____
MEDIUM: _____
DIMENSIONS: _____
PRICE: \$ _____

TITLE 11: _____
YEAR: _____
MEDIUM: _____
DIMENSIONS: _____
PRICE: \$ _____

TITLE 12: _____
YEAR: _____
MEDIUM: _____
DIMENSIONS: _____
PRICE: \$ _____

TITLE 13: _____
YEAR: _____
MEDIUM: _____
DIMENSIONS: _____
PRICE: \$ _____

TITLE 14: _____
YEAR: _____
MEDIUM: _____
DIMENSIONS: _____
PRICE: \$ _____



TITLE 15: _____
YEAR: _____
MEDIUM: _____
DIMENSIONS: _____
PRICE: \$ _____

TITLE 16: _____
YEAR: _____
MEDIUM: _____
DIMENSIONS: _____
PRICE: \$ _____

TITLE 17: _____
YEAR: _____
MEDIUM: _____
DIMENSIONS: _____
PRICE: \$ _____

TITLE 18: _____
YEAR: _____
MEDIUM: _____
DIMENSIONS: _____
PRICE: \$ _____

TITLE 19: _____
YEAR: _____
MEDIUM: _____
DIMENSIONS: _____
PRICE: \$ _____

TITLE 20: _____
YEAR: _____
MEDIUM: _____
DIMENSIONS: _____
PRICE: \$ _____

TITLE 21: _____
YEAR: _____
MEDIUM: _____
DIMENSIONS: _____
PRICE: \$ _____

TITLE 22: _____
YEAR: _____
MEDIUM: _____
DIMENSIONS: _____
PRICE: \$ _____

TITLE 23: _____
YEAR: _____
MEDIUM: _____
DIMENSIONS: _____
PRICE: \$ _____

TITLE 24: _____
YEAR: _____
MEDIUM: _____
DIMENSIONS: _____
PRICE: \$ _____

TITLE 25: _____
YEAR: _____
MEDIUM: _____
DIMENSIONS: _____
PRICE: \$ _____

TITLE 26: _____
YEAR: _____
MEDIUM: _____
DIMENSIONS: _____
PRICE: \$ _____

TITLE 27: _____
YEAR: _____
MEDIUM: _____
DIMENSIONS: _____
PRICE: \$ _____

TITLE 28: _____
YEAR: _____
MEDIUM: _____
DIMENSIONS: _____
PRICE: \$ _____